

| TECHNICAL SPECIFICATIONS | | | | | DIMENSIONS | | | | | | | | | | | | |
|--------------------------|-------------------|------------------------------|---------------------------|----------------------------|------------|------|------------|------|------|-------|-----------|------|------|------|--------|--------|--------|
| Model | Filtering surface | Number of filtering elements | Number of cleaning valves | Compressed air consumption | A | B | B1 | AB* | BB* | H Tot | In | B In | H In | Out | A Out* | B Out* | Weight |
| | [m ²] | | | | [-] | [-] | [Nl/activ] | [mm] | [mm] | [mm] | [mm] | [mm] | [mm] | [mm] | [mm] | [mm] | |
| CFVA145-02x0207 | 10 | 4 | 2 | 87 | 1180 | 700 | 1020 | 1180 | 950 | 5058 | Ø120 | 350 | 3540 | Ø150 | 590 | 475 | 800 |
| CFVA145-02x0210 | 15 | 4 | 2 | 87 | 1180 | 700 | 1020 | 1180 | 1100 | 5458 | Ø150 | 350 | 3825 | Ø180 | 590 | 550 | 850 |
| CFVA145-02x0212 | 18 | 4 | 2 | 87 | 1180 | 700 | 1020 | 1180 | 1100 | 5658 | Ø150 | 350 | 4025 | Ø200 | 590 | 550 | 875 |
| CFVA145-02x0407 | 21 | 8 | 2 | 87 | 1180 | 1180 | 1500 | 1180 | 1180 | 4858 | Ø180 | 350 | 3210 | Ø220 | 590 | 590 | 975 |
| CFVA145-02x0410 | 30 | 8 | 2 | 87 | 1180 | 1180 | 1500 | 1180 | 1180 | 5258 | Ø200 | 350 | 3500 | Ø280 | 590 | 590 | 1025 |
| CFVA145-02x0412 | 37 | 8 | 2 | 87 | 1180 | 1180 | 1500 | 1180 | 1180 | 5458 | Ø220 | 350 | 3690 | Ø300 | 590 | 590 | 1050 |
| CFVA145-03x0307 | 24 | 9 | 3 | 87 | 1420 | 940 | 1260 | 1420 | 940 | 5458 | Ø180 | 290 | 3810 | Ø220 | 710 | 470 | 1000 |
| CFVA145-03x0310 | 34 | 9 | 3 | 87 | 1420 | 940 | 1260 | 1420 | 1250 | 5858 | Ø220 | 290 | 4090 | Ø280 | 710 | 625 | 1100 |
| CFVA145-03x0312 | 41 | 9 | 3 | 87 | 1420 | 940 | 1260 | 1420 | 1250 | 6058 | Ø250 | 290 | 4275 | Ø315 | 710 | 625 | 1150 |
| CFVA145-03x0407 | 31 | 12 | 3 | 87 | 1420 | 1180 | 1500 | 1420 | 1180 | 5358 | Ø200 | 350 | 3600 | Ø280 | 710 | 590 | 1075 |
| CFVA145-03x0410 | 45 | 12 | 3 | 87 | 1420 | 1180 | 1500 | 1420 | 1180 | 5658 | Ø250 | 350 | 3875 | Ø315 | 710 | 590 | 1150 |
| CFVA145-03x0412 | 55 | 12 | 3 | 87 | 1420 | 1180 | 1500 | 1420 | 1180 | 6058 | Ø280 | 350 | 4060 | Ø350 | 710 | 590 | 1225 |
| CFVA145-04x0407 | 42 | 16 | 4 | 87 | 1660 | 1180 | 1500 | 1660 | 1180 | 5658 | Ø250 | 350 | 3875 | Ø315 | 830 | 590 | 1225 |
| CFVA145-04x0410 | 61 | 16 | 4 | 87 | 1660 | 1180 | 1500 | 1660 | 1180 | 6158 | Ø300 | 350 | 4150 | Ø380 | 830 | 590 | 1325 |
| CFVA145-04x0412 | 73 | 16 | 4 | 87 | 1660 | 1180 | 1500 | 1660 | 1180 | 6358 | Ø315 | 350 | 4342 | Ø420 | 830 | 590 | 1375 |
| CFVA145-04x0507 | 52 | 20 | 4 | 217 | 1660 | 1420 | 1780 | 1660 | 1420 | 5558 | Ø280 | 410 | 3760 | Ø350 | 830 | 710 | 1425 |
| CFVA145-04x0510 | 76 | 20 | 4 | 217 | 1660 | 1420 | 1780 | 1660 | 1420 | 6058 | Ø315 | 410 | 4042 | Ø420 | 830 | 710 | 1525 |
| CFVA145-04x0512 | 91 | 20 | 4 | 217 | 1660 | 1420 | 1780 | 1660 | 1420 | 6258 | Ø350 | 410 | 4225 | Ø450 | 830 | 710 | 1575 |
| CFVA145-05x0507 | 66 | 25 | 5 | 217 | 1900 | 1420 | 1780 | 1900 | 1420 | 5758 | Ø300 | 410 | 3750 | Ø400 | 950 | 710 | 1550 |
| CFVA145-05x0510 | 95 | 25 | 5 | 217 | 1900 | 1420 | 1780 | 1900 | 1420 | 6058 | Ø350 | 410 | 4025 | Ø480 | 950 | 710 | 1650 |
| CFVA145-05x0512 | 114 | 25 | 5 | 217 | 1900 | 1420 | 1780 | 1900 | 1420 | 6258 | Ø400 | 410 | 4200 | Ø520 | 950 | 710 | 1700 |
| CFVA145-05x0607 | 79 | 30 | 5 | 217 | 1900 | 1660 | 2020 | 1900 | 1660 | 5758 | Ø315 | 830 | 3742 | Ø420 | 950 | 830 | 1700 |
| CFVA145-05x0610 | 114 | 30 | 5 | 217 | 1900 | 1660 | 2020 | 1900 | 1660 | 6058 | Ø400 | 830 | 4000 | Ø520 | 950 | 830 | 1800 |
| CFVA145-05x0612 | 137 | 30 | 5 | 217 | 1900 | 1660 | 2020 | 1900 | 1660 | 6358 | Ø450 | 830 | 4175 | Ø580 | 950 | 830 | 1875 |
| CFVA325-02x0207 | 33-43*** | 4 | 2 | 217 | 1390 | 960 | 1320 | 1390 | 960 | 5858 | Ø250 | 265 | 4075 | Ø315 | 695 | 480 | 1200 |
| CFVA325-02x0210 | 48-63*** | 4 | 2 | 217 | 1390 | 960 | 1320 | 1390 | 1400 | 6358 | Ø300 | 265 | 4350 | Ø380 | 695 | 700 | 1325 |
| CFVA325-02x0212 | 58-76*** | 4 | 2 | 217 | 1390 | 960 | 1320 | 1390 | 1400 | 6558 | Ø315 | 265 | 4542 | Ø420 | 695 | 700 | 1375 |
| CFVA325-03x0207 | 50-65*** | 6 | 3 | 217 | 1820 | 960 | 1320 | 1820 | 1400 | 6058 | Ø300 | 265 | 4050 | Ø380 | 910 | 700 | 1425 |
| CFVA325-03x0210 | 72-94*** | 6 | 3 | 217 | 1820 | 960 | 1320 | 1820 | 1500 | 6358 | 350 x 300 | 265 | 4350 | Ø480 | 910 | 750 | 1525 |
| CFVA325-03x0212 | 87-113*** | 6 | 3 | 217 | 1820 | 960 | 1320 | 1820 | 1550 | 6558 | 350 x 400 | 265 | 4500 | Ø520 | 910 | 775 | 1575 |
| CFVA325-03x0307 | 75-98*** | 9 | 3 | 217 | 1820 | 1390 | 1750 | 1820 | 1390 | 5758 | Ø380 | 373 | 3710 | Ø480 | 910 | 695 | 1575 |
| CFVA325-03x0310 | 109-141*** | 9 | 3 | 217 | 1820 | 1390 | 1750 | 1820 | 1390 | 6158 | Ø450 | 373 | 3975 | Ø580 | 910 | 695 | 1700 |
| CFVA325-03x0312 | 131-170*** | 9 | 3 | 217 | 1820 | 1390 | 1750 | 1820 | 1390 | 6458 | Ø480 | 373 | 4160 | Ø630 | 910 | 695 | 1775 |
| CFVA325-04x0307 | 100-130*** | 12 | 4 | 217 | 2250 | 1390 | 1750 | 2250 | 1390 | 6158 | Ø420 | 373 | 3990 | Ø550 | 1125 | 695 | 1850 |
| CFVA325-04x0310 | 145-188*** | 12 | 4 | 217 | 2250 | 1390 | 1750 | 2250 | 1390 | 6658 | Ø520 | 373 | 4240 | Ø650 | 1125 | 695 | 1975 |
| CFVA325-04x0312 | 175-227*** | 12 | 4 | 217 | 2250 | 1390 | 1750 | 2250 | 1390 | 6858 | 350 x 750 | 373 | 4325 | Ø710 | 1125 | 695 | 2050 |
| CFVA325-04x0407 | 134-173*** | 16 | 4 | 347 | 2250 | 1820 | 2220 | 2250 | 1820 | 6158 | Ø500 | 480 | 3850 | Ø630 | 1125 | 910 | 2300 |
| CFVA325-04x0410 | 193-251*** | 16 | 4 | 347 | 2250 | 1820 | 2220 | 2250 | 1820 | 6558 | Ø600 | 480 | 4100 | Ø750 | 1125 | 910 | 2425 |
| CFVA325-04x0412 | 233-302*** | 16 | 4 | 347 | 2250 | 1820 | 2220 | 2250 | 1820 | 6858 | Ø650 | 480 | 4275 | Ø850 | 1125 | 910 | 2550 |

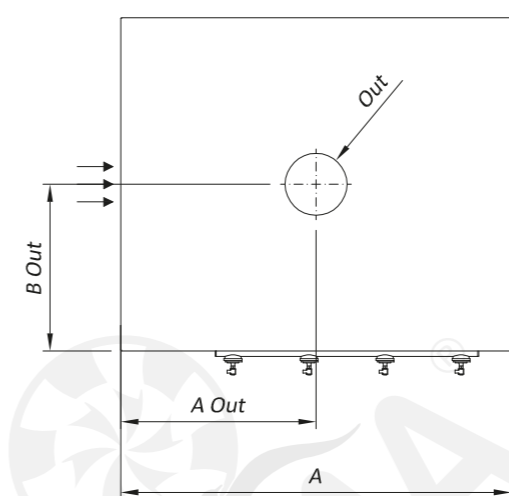
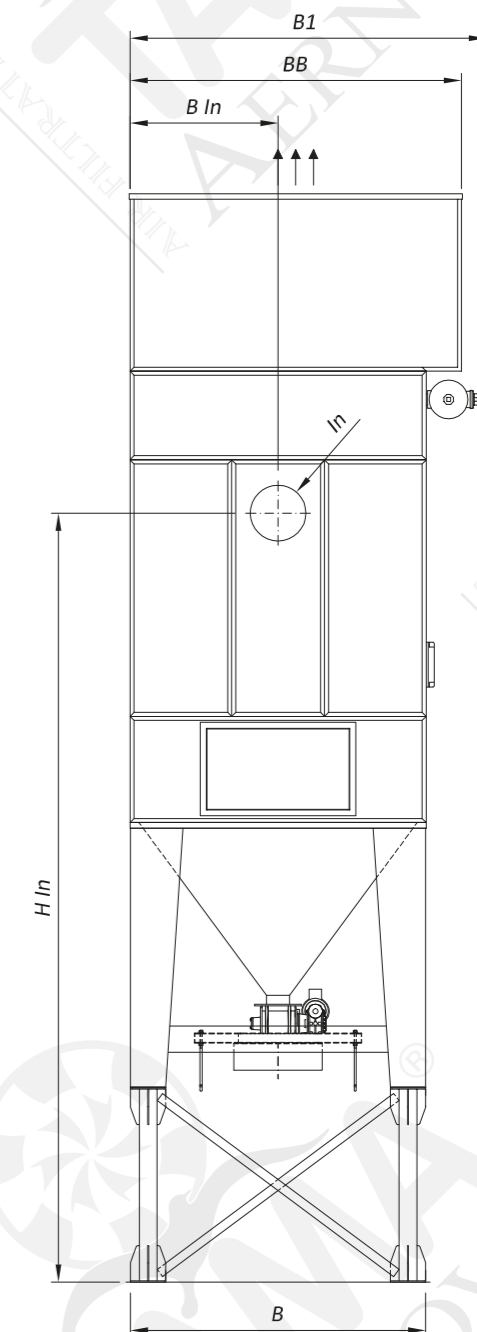
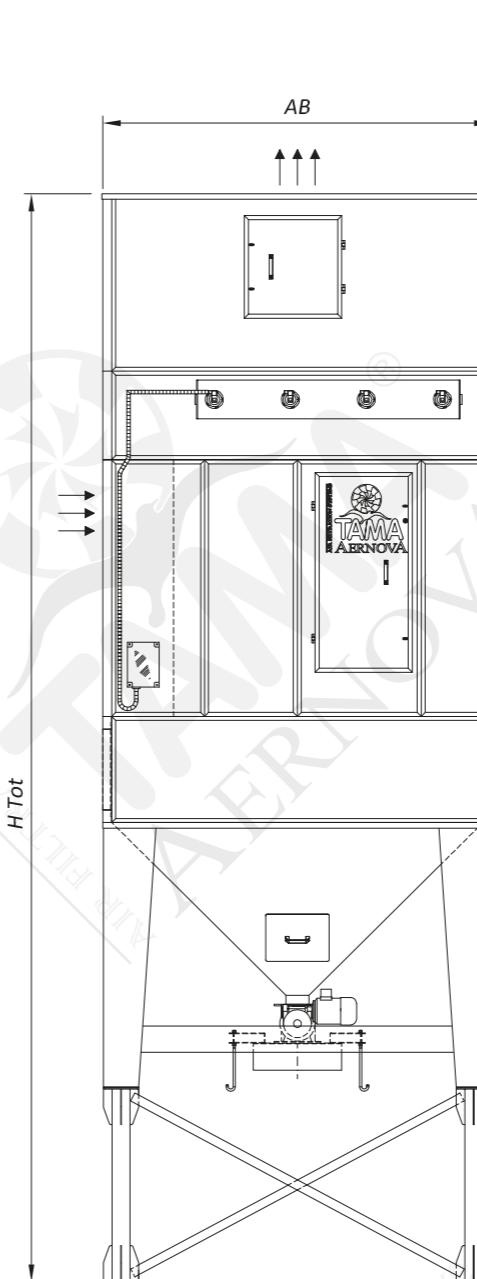

| TECHNICAL SPECIFICATIONS | | |
|---|--|----------|
| Certification code | II 3 D Ex h IIC T200°C Dc -10°C<T<40°C | |
| Max working negative pressure | Pa | 5000 |
| Working Temperature | °C | -10<T<40 |
| Electric control panel feeding | 230 V AC 50Hz | |
| Cartridge cleaning system | pulse-jet | |
| Compressed air tank working pressure | bar | 5 |
| Rotary valve solid discharge** | mc/h | 2 |
| Rotary valve power** | kW | 0,5 |
| Average level of sound pressure LpA_1.5 m [UNI EN ISO 3746:1997]* | dB(A) | <80 |

* The level of sound pressure is affected by the background noise, the reverberation of the environment, the presence of other sound sources and the positioning of the machine near reflecting surfaces. In the installations common conditions it is necessary to use corrective coefficients. This value depends also from the level of sound pressure of the fan.
** The rotary valve is available also with other configurations. The data are referred to a single rotary valve.

* Dimensions referred to fan box | *** Filtering surface for cartridges with 175 pleats

| Model | EXPLOSION CHARACTERISTICS | | | DIMENSIONS | | |
|-----------------|---------------------------|-------|-----------|------------|-----|-----|
| | Number of venting panels | P max | Kst | LF | WF | TF |
| | [-] | [bar] | [m bar/s] | [m] | [m] | [m] |
| CFVA145-02x0207 | 1 | 8,9 | 199 | 12 | 4 | 4 |
| CFVA145-02x0210 | 1 | 8,9 | 199 | 12 | 4 | 4 |
| CFVA145-02x0212 | 1 | 8,9 | 199 | 12 | 4 | 4 |
| CFVA145-02x0407 | 1 | 8,9 | 199 | 13 | 4 | 4 |
| CFVA145-02x0410 | 1 | 8,9 | 199 | 14 | 4 | 4 |
| CFVA145-02x0412 | 1 | 8 | 150 | 14 | 4 | 4 |
| CFVA145-03x0307 | 1 | 8,9 | 199 | 13 | 4 | 4 |
| CFVA145-03x0310 | 1 | 8,9 | 199 | 14 | 4 | 4 |
| CFVA145-03x0312 | 1 | 8 | 150 | 14 | 4 | 4 |
| CFVA145-03x0407 | 1 | 8,9 | 199 | 14 | 4 | 4 |
| CFVA145-03x0410 | 1 | 8 | 150 | 15 | 4 | 4 |
| CFVA145-03x0412 | 1 | 8 | 150 | 15 | 5 | 5 |
| CFVA145-04x0407 | 1 | 8,9 | 199 | 15 | 5 | 5 |
| CFVA145-04x0410 | 1 | 8 | 150 | 16 | 5 | 5 |
| CFVA145-04x0412 | 1 | 8 | 150 | 16 | 5 | 5 |
| CFVA145-04x0507 | 1 | 8,9 | 199 | 16 | 5 | 5 |
| CFVA145-04x0510 | 1 | 8 | 150 | 17 | 5 | 5 |
| CFVA145-04x0512 | 1 | 8 | 150 | 17 | 5 | 5 |
| CFVA145-05x0507 | 1 | 8,9 | 199 | 17 | 5 | 5 |
| CFVA145-05x0510 | 1 | 8 | 180 | 17 | 5 | 5 |
| CFVA145-05x0512 | 1 | 8 | 150 | 18 | 5 | 5 |
| CFVA145-05x0607 | 1 | 8,9 | 180 | 18 | 5 | 5 |
| CFVA145-05x0610 | 1 | 8 | 160 | 18 | 5 | 5 |
| CFVA145-05x0612 | 1 | 8 | 150 | 19 | 6 | 6 |
| CFVA325-02x0207 | 1 | 8,9 | 199 | 13 | 4 | 4 |
| CFVA325-02x0210 | 1 | 8,9 | 199 | 13 | 4 | 4 |
| CFVA325-02x0212 | 1 | 8,9 | 199 | 13 | 4 | 4 |
| CFVA325-03x0207 | 1 | 8,9 | 199 | 14 | 4 | 4 |
| CFVA325-03x0210 | 1 | 8,9 | 199 | 14 | 4 | 4 |
| CFVA325-03x0212 | 1 | 8 | 150 | 14 | 4 | 4 |
| CFVA325-03x0307 | 1 | 8,9 | 199 | 15 | 5 | 5 |
| CFVA325-03x0310 | 1 | 8 | 150 | 16 | 5 | 5 |
| CFVA325-03x0312 | 1 | 8 | 150 | 16 | 5 | 5 |
| CFVA325-04x0307 | 2 | 8,9 | 199 | 17 | 6 | 5 |
| CFVA325-04x0310 | 2 | 8,9 | 199 | 17 | 6 | 5 |
| CFVA325-04x0312 | 2 | 8,9 | 199 | 17 | 6 | 5 |
| CFVA325-04x0407 | 2 | 8,9 | 199 | 18 | 6 | 5 |
| CFVA325-04x0410 | 2 | 8,9 | 199 | 19 | 7 | 6 |
| CFVA325-04x0412 | 2 | 8,9 | 199 | 19 | 7 | 6 |

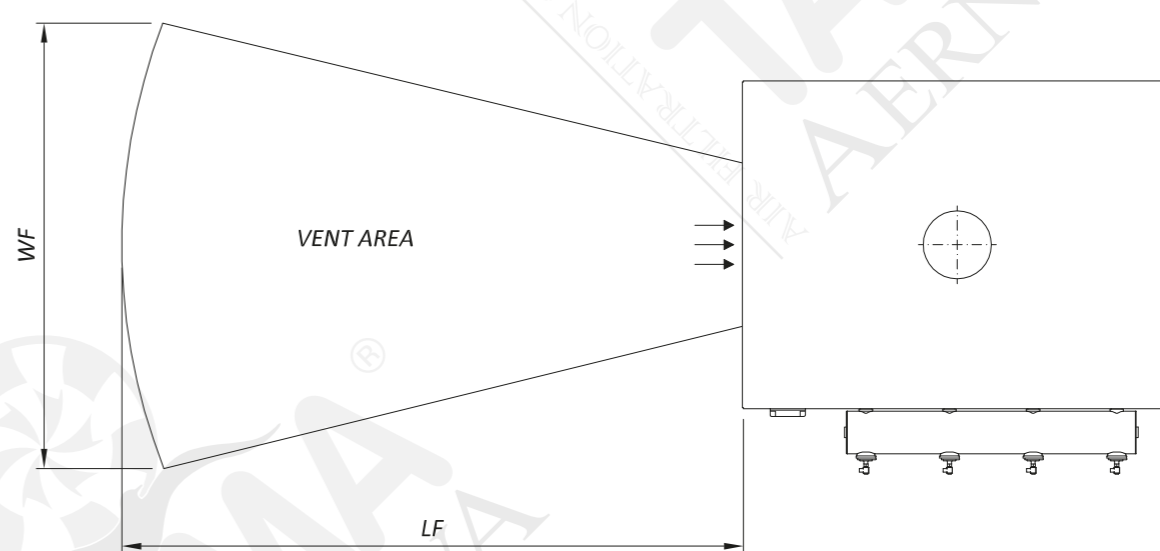
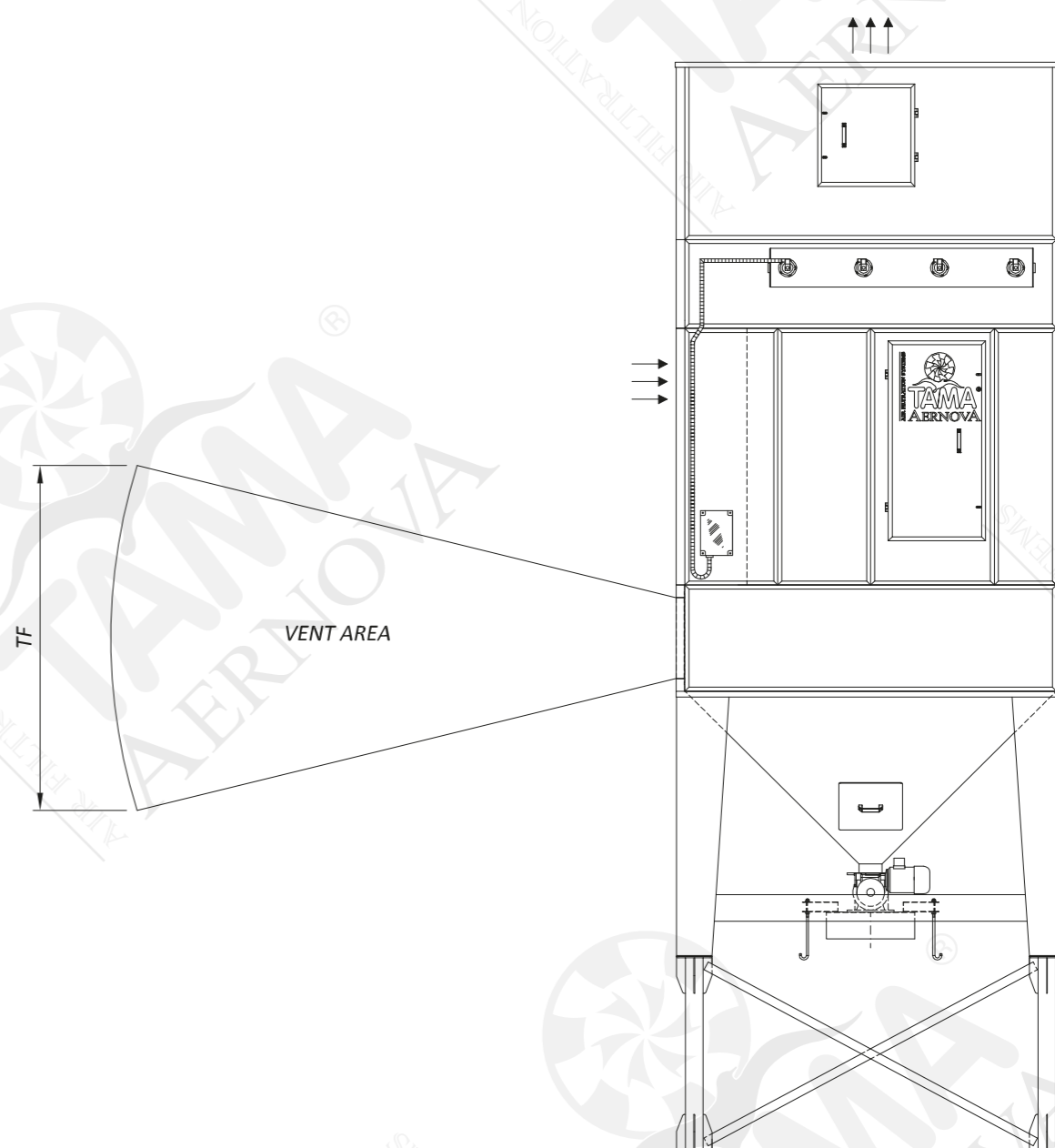

| EXPLOSION CHARACTERISTICS | | | | DIMENSIONS | | |
|---------------------------|--------------------------|-------|-----------|------------|-----|-----|
| Model | Number of venting panels | P max | Kst | LF | WF | TF |
| | [-] | [bar] | [m bar/s] | [m] | [m] | [m] |
| CFVA145-08x0407 | 2 | 8,9 | 199 | 18 | 6 | 5 |
| CFVA145-08x0410 | 2 | 8,9 | 199 | 19 | 7 | 6 |
| CFVA145-08x0412 | 2 | 8,9 | 199 | 20 | 7 | 6 |
| CFVA145-08x0507 | 2 | 8,9 | 199 | 19 | 7 | 6 |
| CFVA145-08x0510 | 2 | 8,9 | 199 | 20 | 7 | 6 |
| CFVA145-08x0512 | 2 | 8,9 | 199 | 21 | 7 | 6 |
| CFVA145-08x0607 | 2 | 8,9 | 199 | 20 | 7 | 6 |
| CFVA145-08x0610 | 2 | 8,9 | 199 | 21 | 7 | 6 |
| CFVA145-08x0612 | 2 | 8,9 | 199 | 21 | 7 | 6 |
| CFVA145-12x0507 | 2 | 8,9 | 199 | 22 | 9 | 7 |
| CFVA145-12x0510 | 3 | 8,9 | 199 | 23 | 9 | 7 |
| CFVA145-12x0512 | 3 | 8,9 | 199 | 24 | 9 | 7 |
| CFVA145-16x0407 | 3 | 8,9 | 199 | 23 | 10 | 7 |
| CFVA145-16x0410 | 3 | 8,9 | 199 | 24 | 10 | 7 |
| CFVA145-16x0412 | 3 | 8,9 | 199 | 25 | 10 | 7 |
| CFVA145-14x0507 | 3 | 8,9 | 199 | 23 | 10 | 7 |
| CFVA145-14x0510 | 3 | 8,9 | 199 | 24 | 10 | 7 |
| CFVA145-14x0512 | 3 | 8,9 | 199 | 25 | 10 | 7 |
| CFVA145-12x0607 | 3 | 8,9 | 199 | 23 | 9 | 7 |
| CFVA145-12x0610 | 3 | 8,9 | 199 | 24 | 9 | 7 |
| CFVA145-12x0612 | 3 | 8,9 | 199 | 25 | 9 | 7 |
| CFVA145-16x0507 | 3 | 8,9 | 199 | 24 | 10 | 7 |
| CFVA145-16x0510 | 3 | 8,9 | 199 | 25 | 10 | 7 |
| CFVA145-16x0512 | 3 | 8,9 | 199 | 26 | 11 | 8 |
| CFVA145-14x0607 | 3 | 8,9 | 199 | 24 | 10 | 7 |
| CFVA145-14x0610 | 3 | 8,9 | 199 | 25 | 10 | 7 |
| CFVA145-14x0612 | 3 | 8,9 | 199 | 26 | 11 | 8 |
| CFVA145-16x0607 | 3 | 8,9 | 199 | 25 | 10 | 7 |
| CFVA145-16x0610 | 3 | 8,9 | 199 | 26 | 11 | 8 |
| CFVA145-16x0612 | 4 | 8,9 | 199 | 27 | 11 | 8 |
| CFVA145-20x0507 | 3 | 8,9 | 199 | 26 | 11 | 8 |
| CFVA145-20x0510 | 4 | 8,9 | 199 | 27 | 12 | 8 |
| CFVA145-20x0512 | 4 | 8,9 | 199 | 28 | 12 | 8 |
| CFVA325-04x0207 | 1 | 8,9 | 199 | 16 | 5 | 5 |
| CFVA325-04x0210 | 1 | 8 | 150 | 16 | 5 | 5 |
| CFVA325-04x0212 | 1 | 8 | 150 | 16 | 5 | 5 |
| CFVA325-05x0307 | 2 | 8,9 | 199 | 18 | 6 | 5 |
| CFVA325-05x0310 | 2 | 8,9 | 199 | 19 | 7 | 6 |
| CFVA325-05x0312 | 2 | 8,9 | 199 | 19 | 7 | 6 |
| CFVA325-05x0407 | 2 | 8,9 | 199 | 20 | 7 | 6 |
| CFVA325-05x0410 | 2 | 8,9 | 199 | 20 | 7 | 6 |
| CFVA325-05x0412 | 2 | 8,9 | 199 | 20 | 7 | 6 |
| CFVA325-06x0407 | 2 | 8,9 | 199 | 21 | 8 | 6 |
| CFVA325-06x0410 | 2 | 8,9 | 199 | 21 | 8 | 6 |
| CFVA325-06x0412 | 2 | 8,9 | 199 | 22 | 8 | 6 |
| CFVA325-08x0407 | 3 | 8,9 | 199 | 23 | 10 | 7 |
| CFVA325-08x0410 | 3 | 8,9 | 199 | 23 | 10 | 7 |
| CFVA325-08x0412 | 3 | 8,9 | 199 | 24 | 10 | 7 |
| CFVA325-12x0407 | 4 | 8,9 | 199 | 26 | 12 | 8 |
| CFVA325-12x0410 | 4 | 8,9 | 199 | 27 | 12 | 8 |
| CFVA325-12x0412 | 4 | 8,9 | 199 | 27 | 12 | 8 |

